



LG Wall TV / Soundbar Update

4/16 Replacement Installation Instructions

ITEMS / TOOLS NEEDED:

- (1) Eletrical / Blue Tape
- (1) Tape Measure

PRODUCT NEEDED:

- (1) 65E7 LG TV
- (1) SJ8570 LG TV
- (1) SJ9 Soundbar
- (1) SJ8 Soundbar

KIT INCLUDES:

- (1) SJ9 USB Update Stick
- (1) SJ8 USB Update Stick
- (1) SH5 Recovery USB Stick
- (1) HDMI Splitter

- (2) 6ft HDMI Cables
- (1) Price Holders
- (2) M4 Washers
- (2) 7x18mm M4 Screws

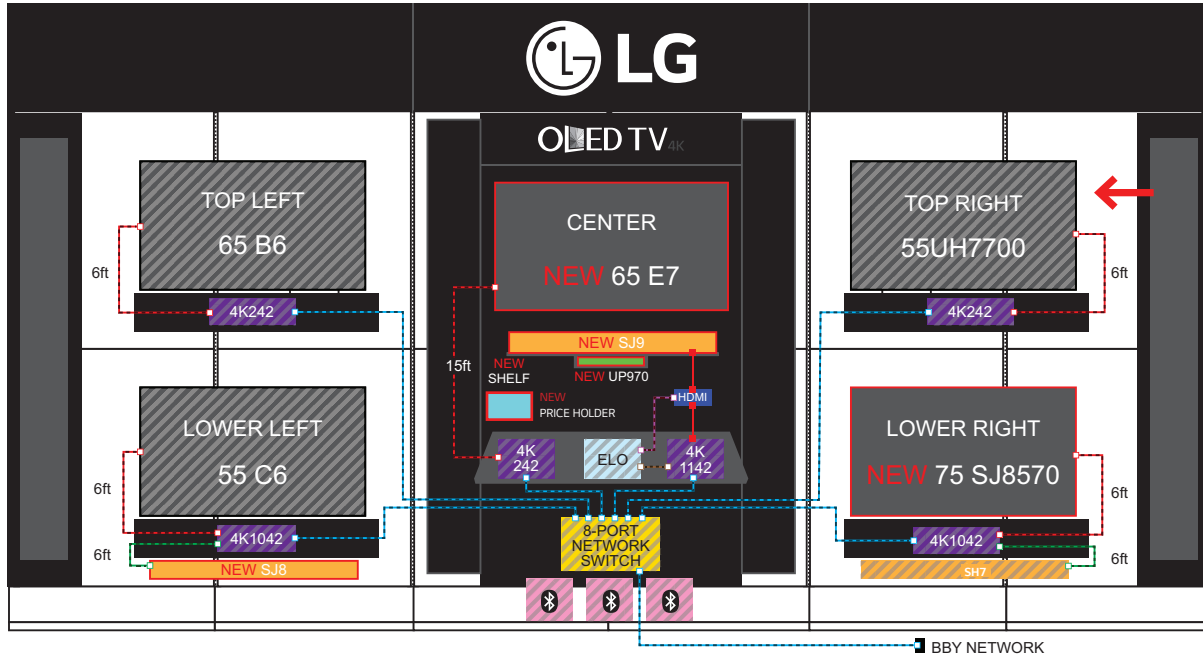

IMPORTANT NOTE:
This installation requires 2 people.

1. Move the Lower Right TV 55UH7700 to Top Right Shelf

1A: First unplug and remove the **LOWER RIGHT TV 55UH7700** set this off to the side this will be moved to the **TOP RIGHT** position shortly.

1B: Unplug and remove the **TOP RIGHT TV 65UH8500** and **MOVED TO OPEN BOX SALES**

1C: Reposition the **LOWER RIGHT TV 55UH7700** to the **TOP RIGHT SHELF** plug the power cable and HDMI cables back into the TV.



2. Install NEW Lower Right SJ8570 TV

2A: The **LOWER RIGHT TV Shelf** must be lowered in order to fit the **NEW SJ8570 TV**. Do that before installing the **NEW SJ8570 TV**. Unhook and reposition the shelf so that it is 9.5" from the bottom.

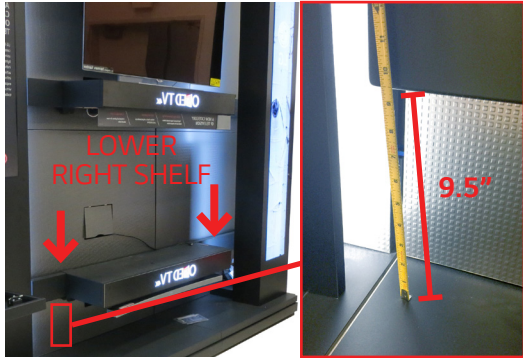

2B: INSTALL THE NEW LOWER Right TV (SJ8570). Locate the (1) HDMI Cable that was connected to the OLD TV and plug that cable in Plug TV's power cord in. Push any excess cables into the cable management hole.

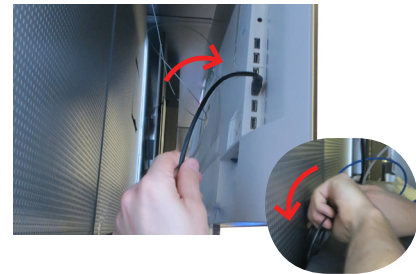

3. Remove Lower Left SH5 Soundbar

3A: Unplug the (1) Optical Cable from the **SH5** and any additional cables / power cords plugged into the **SH5**. Remove **SH5** from the display. Refer to **STEP 11** to revert unit's firmware to original settings. and **MOVE TO OPEN BOX SALES**.

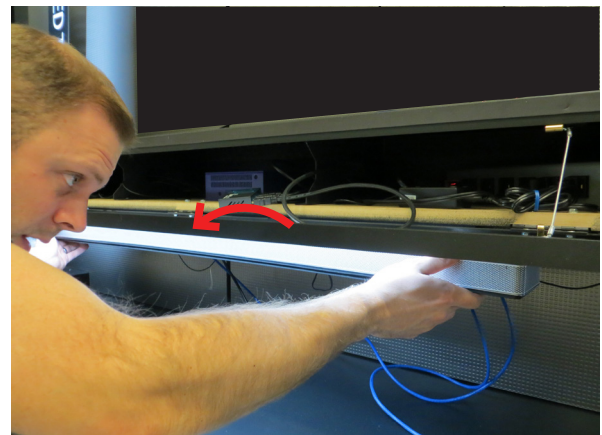
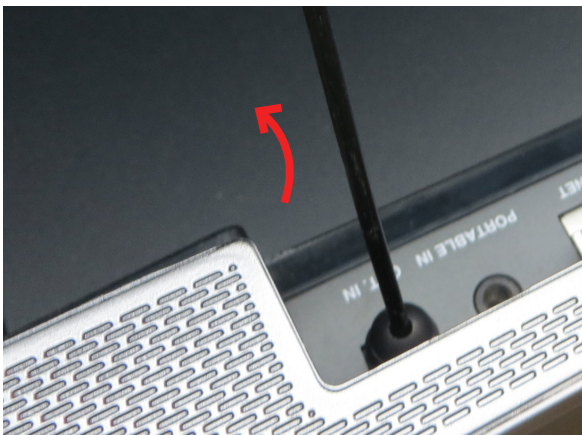

3B: Move the (1) Optical Cable from the **SH5** and feed it through the lower left cable management hole so that the cables are above the lower left shelf.

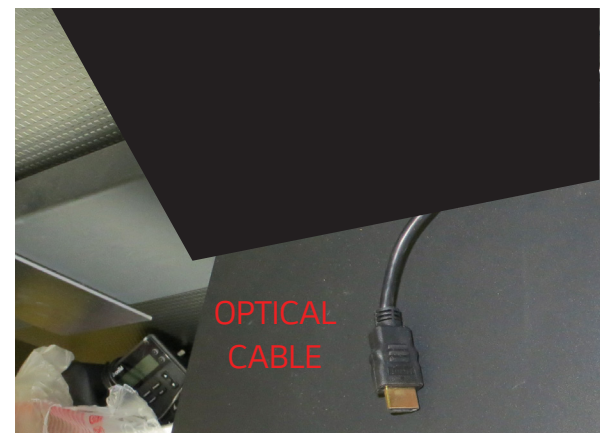

4. Install NEW Lower Left SJ8 Soundbar

4A: INSTALL THE NEW LOWER LEFT SOUNDBAR (SJ8). Locate and Remove the **SJ8** from the packaging. Locate the Soundbar Feet and Install onto the unit. Place the soundbar ontop of the Lower Left Shelf. Update SJ8's firmware on **STEP 10**.

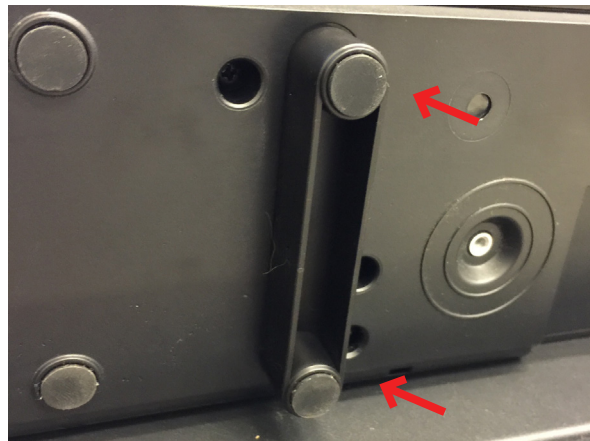
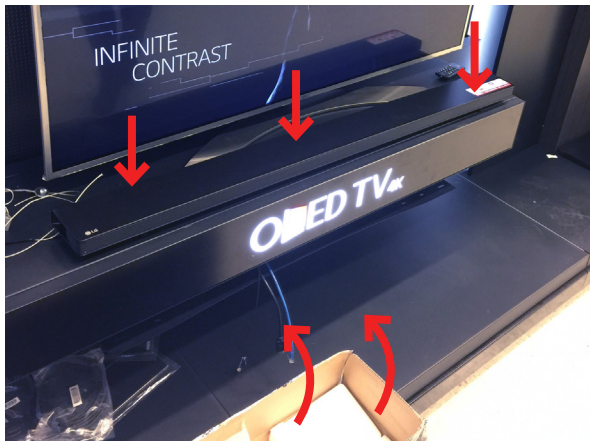

4B: Plug the (1) Optical Cable into the SJ8 and plug in any power cables. Pull any extra cables into the cable management holes on the bottom of the shelf.



5. Removing Center TV / Shelf / LAS950 Soundbar

5A: Remove the OLD Center TV & Remove the OLD Center Bracket and Shelf. **MOVE TV TO OPEN BOX SALES.**

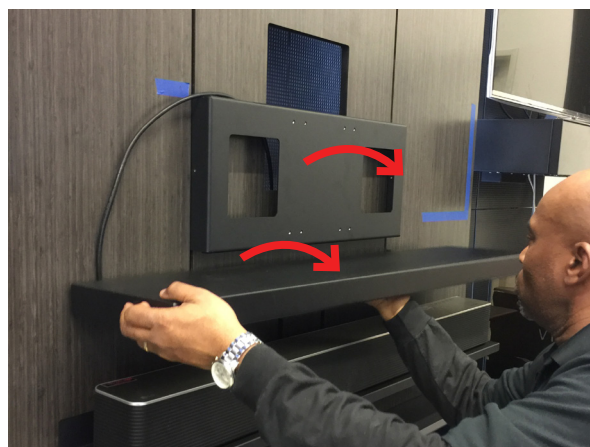

5B: Remove OLD Center Soundbar (**LAS950**) and Remove the OLD Center Soundbar Shelf. **MOVE TO OPEN BOX SALES.** Take the **LAS950** out of **DEMO** mode. Press the **"ADD"** button until **"RESET"** shows on the soundbar.



6. Installing NEW Center TV

6A: Install NEW Center TV Mount onto the **NEW 65E7 TV**. Make sure to install on the lower screw holes of the mounting bracket. Screw in Locking brackets on both sides of the mounting bracket before mounting.

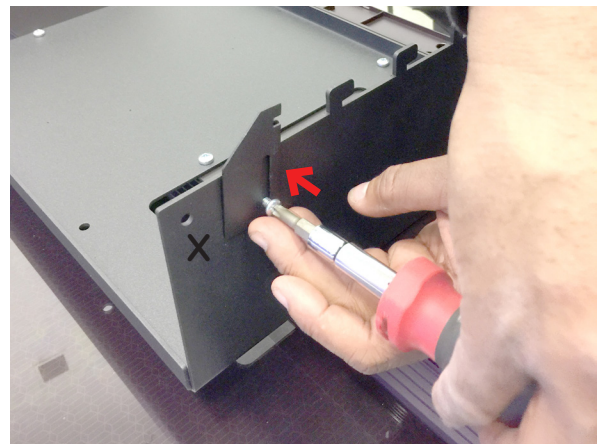
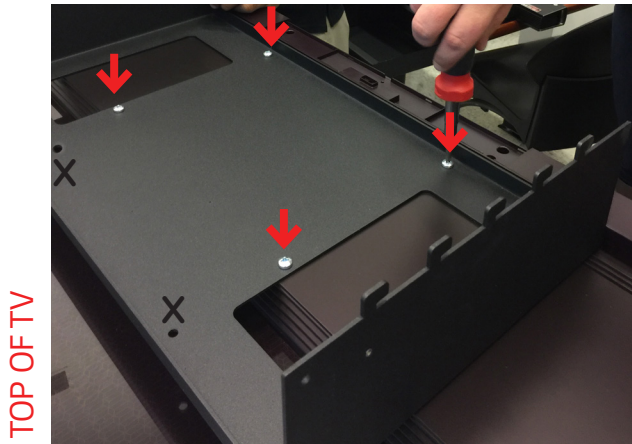

6B: Add easy removable Tape where the top of the mounting hooks are needed for both the New TV Mounting bracket and the New Soundbar shelf. The TV Bracket will be placed 8 Notches DOWN from the TOP. The Soundbar shelf will be 3 Notches UP from the BOTTOM.

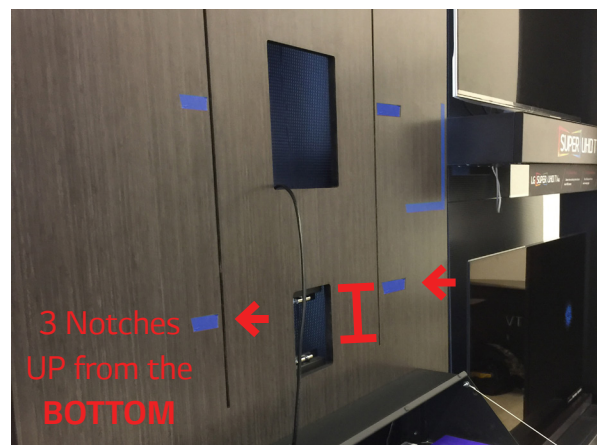

6C: Plug (1) OLD HDMI Cable into the **NEW 65E7 TV** .Install TV so that it locks into the supports. Making sure the Mount is level, Then Lock the security bracket and tighten the screws. Position the new Bracket So that the top of the bracket rest inside the 8th Notch down from the TOP

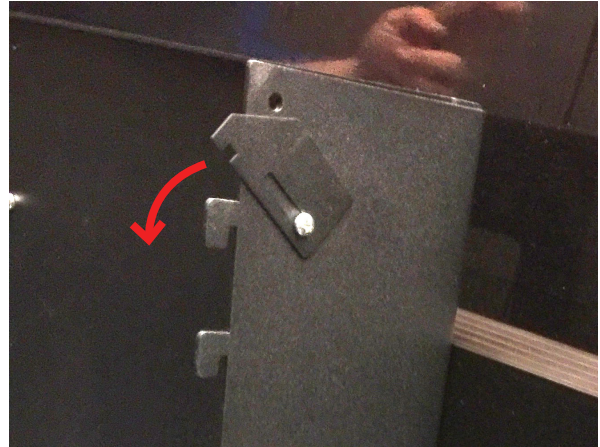

7. Installing NEW Center SJ9 Soundbar

7A: Install the new Soundbar Shelf then Place the new Soundbar (**SJ9**) onto the shelf. Loop the (1) HDMI Cable through the cable management holes on the shelf. Position Soundbar so that it is centered on the shelf. Update SJ9's Firware on **STEP 9**.



7B: Plug the (1) HDMI Cable into the **SJ9**



8. Adding HDMI Splitter for Center TV

8A: Locate a (1) HDMI Splitter and (2) HDMI Cables The Cables will be plugged in the configuration on the diagram below: **MAKE SURE HDMI IN GOES INTO MEDIA PLAYER**

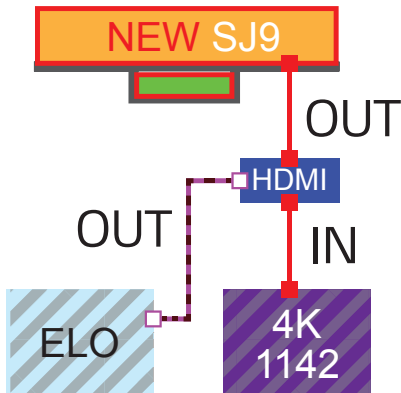

8B: Plug (1) HDMI Cable Coming from the ELO into an HDMI OUT Port, Plug (1) HDMI Cable coming from the Soundbar into another HDMI OUT Port.



8C: Plug (1) HDMI Cable from the HDMI Splitter to the 4K1142 Media Center **MAKE SURE THIS GOES INTO THE HDMI IN** Port. Plug the HDMI Splitter into a Power Outlet.



9. Update SJ9 Firmware

9A: Power the unit ON.

9B: Plug the USB Stick **SJ9** just above Ethernet cable

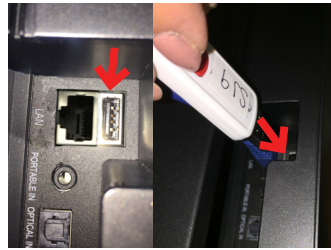

9C: **UPGRADE** will show on screen Press Play on Remote



9D: **B-UPDATE** will show then **M-UPDATE**

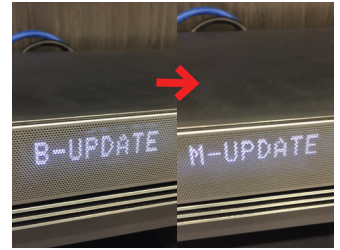

9E: Unit will Restart when update is complete Unplug USB. **Unplug if unit says "Please Wait"**

9F: Press "F" Until **HDMI IN** is selected.

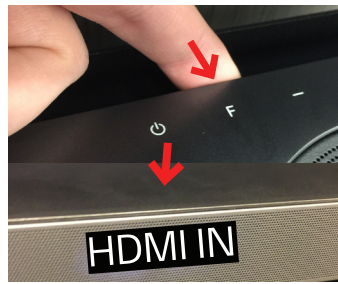

9G: To Enter **DEMO** mode, press volume up until it is at 24 then press & hold "F" button until 'DEMO' appear.

9H: Use the touch panel to enter **SOUND DEMO** mode to confirm that the unit plays properly.

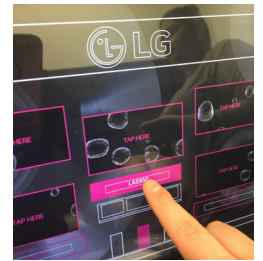
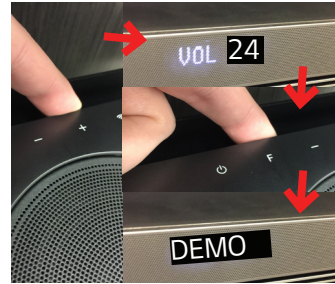

10. Update SJ8 Firmware

10A: Power the unit ON.

10B: Plug the USB Stick **SJ8** on the bottom of the unit.

10C: **UPGRADE** will show on screen Press Play on Remote

10D: **B-UPDATE** will show then **M-UPDATE**

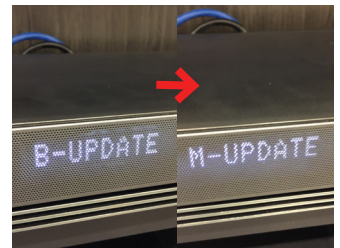

10E: Unit will Restart when update is complete Unplug USB. **Unplug if unit says "Please Wait"**

10F: Press "F" Until **OPTICAL** is selected.

10G: To Enter **DEMO** mode, press volume up until it is at 20 then press & hold "F" button until 'DEMO' appear.

10H: Use the touch panel to enter **SOUND DEMO** mode to confirm that the unit plays properly.

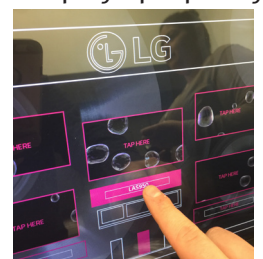
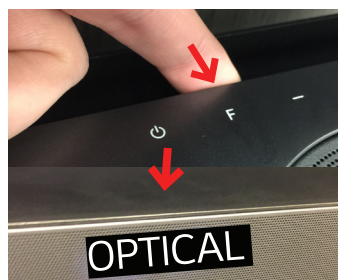

11. Recover SH5 Firmware

Before starting the update, you will need to return the SH5B soundbar to its original firmware status.

11A: To enter the hidden USB function, push Vol- on the soundbar first and hold while pushing the Vol+ on the remote for 3 seconds.



PRESS TOGETHER FOR 3 SECONDS

11B: Once the soundbar is on USB function, plug the SH5B USB drive and process Update.



11C: After update, the status changes to normal. **MOVE TO OPEN BOX SALES**

12. Install New Price Holder

12A: Remove (2) tape backer strips and position the price holder just below the existing left side price holder, Push against the wall to secure the holder. **NOTE:** Make sure the holder's opening is facing up.

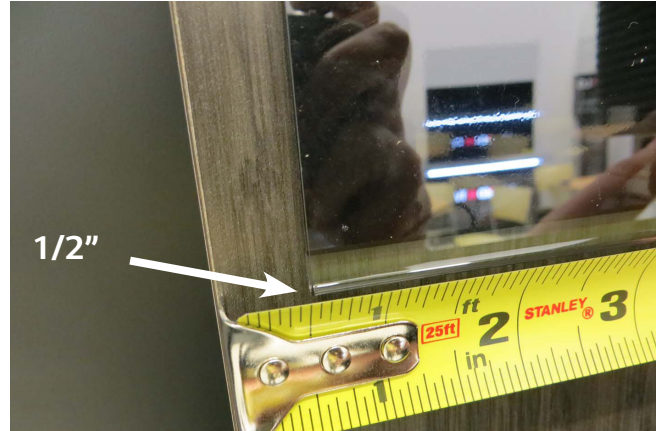

13. Secure SJ9 Soundbar to the Shelf

13A: Locate (2) M4 Washers and (2) 7x18mm M4 Screws and screw one set on each side of the Soundbar shelf, **MAKE SURE TO DO THIS AFTER ALL SOUNDBAR CABLES ARE PLUGGED IN.**



Assembly Complete.

If you have any questions regarding this display, please call: 1-800-826-0626

WALL WIRE DIAGRAM (2017)

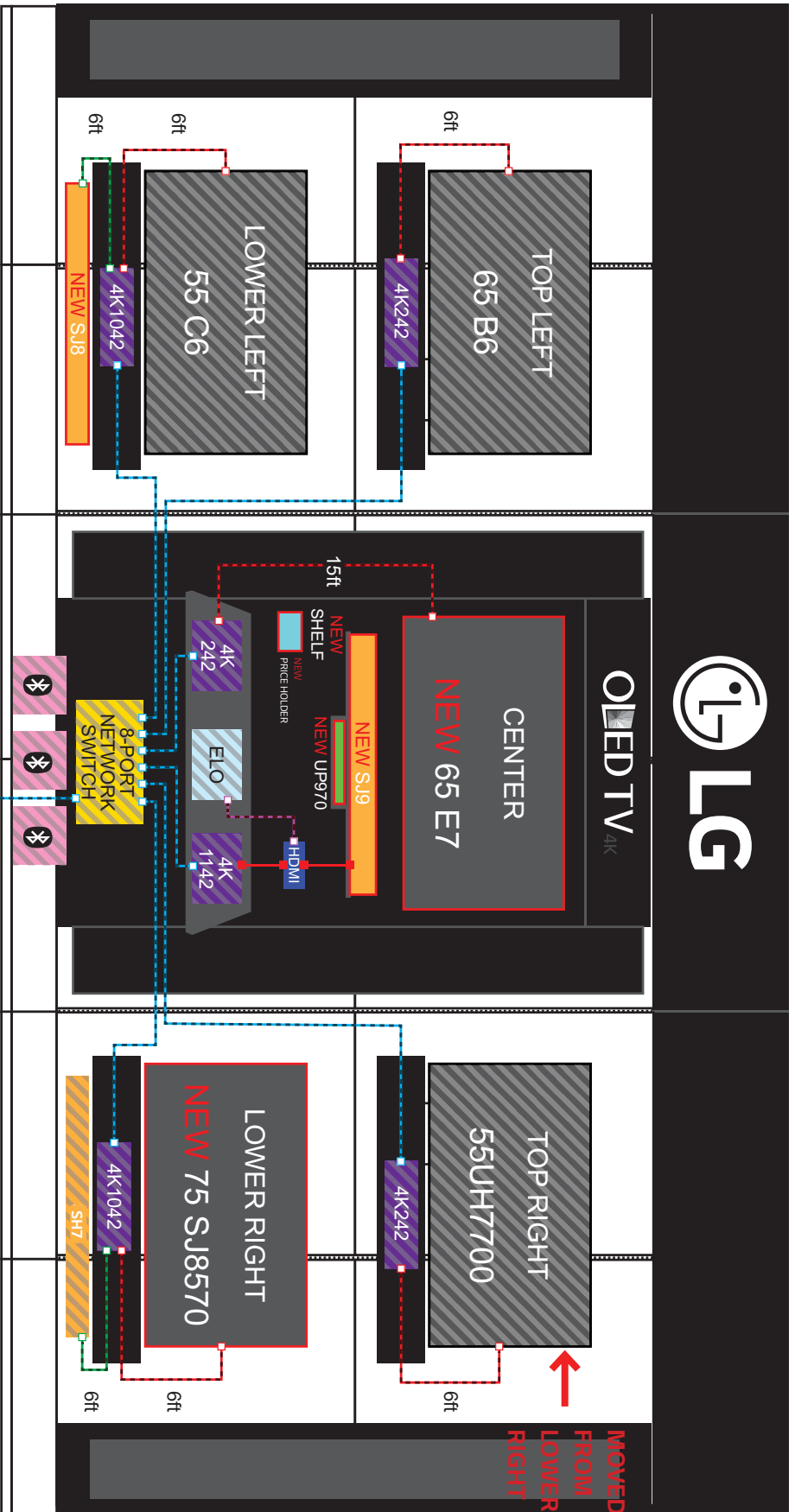

Please replace current wire diagram in display with NEW wire diagram drawing.

CABLE LIST

- (7) OLD NETWORK CABLES
- (5) OLD HDMI CABLES
- (2) NEW HDMI CABLES
- (1) HDMI OUT to DVI-D
- (3) OLD OPTICAL CABLES

- (6) MEDIA PLAYER
- (1) OLD NETWORK SWITCH (8-PORT)
- (1) ELO TOUCH SCREEN
- (1) HDMI SPLITTER

ACCESSORY LIST

- (1) NEW BLURAY
- (2) NEW TV
- (3) OLD TV
- (3) SUBWOOFERS
- (1) OLD SOUNDBARS
- (2) NEW SOUNDBAR
- (1) PRICE HOLDER